



A Chris Alston's Chassisworks, Inc. Brand

VariStrut

VariStrut Drag Race Suspension is a new design with an integral spindle that allows us to provide additional travel while fitting into existing chassis.

VariStrut
with upper stem mount and
medium-duty brake kit



VariStrut Front Struts include:

- Double-adjustable QuickSet 2 strut body with integral spindle
- Light weight brake kit using 2-piston calipers and 10" solid rotors
- 4 inches of travel versus 2-1/2 in competitive models
- Your choice of spring rate

Optionally Available

- Spindle mount wheel brake kit with slotted rotor and floating caliper for weld wheels 78815001 & 78615001
- Medium-duty brake kit using 4-piston calipers and 11.75" solid rotors
- Slotted rotors available in 10" and 11-3/4" diameter
- Control arms are sold in pairs. They feature a high-misalignment, 5/8" -bore, Teflon-lined, spherical bearing, pivot-stud-bearing housing mechanism; 4130 tubes; and 1/2" -thread tube adapters
- Rod ends are available in two sizes to match 7/16" or 1/2" chassis attachments
- Tie-rod tubes are designed to replace the stock-Pinto-rack tie rod with 5/8" -OD, 4130 tube and high-misalignment rod ends
- Spherical bearing chassis mount for stem top struts
- Poly pad strut-top chassis mount for stem top struts

VariStrut is a new family of racing front struts designed and manufactured in the United States. The CNC-machined strut assembly incorporates all the features of our double-adjustable VariShock. It uses our 1-piece, self-locking lower spring seat. The base is machined out of billet stainless steel to incorporate the lower body with axle. The steering arm, lower A-arm mounting stud, and brake-caliper bracket bolt directly to the base. This compact unit allows us to drop the shock reservoir below the center of the axle. The axle does not press in, which significantly increases available travel. VariStruts are available in 4"-travel aluminum-reservoir and 6"-travel 4130-reservoir configurations. Total suspension travel is increased 60% or greater when compared to struts that offer only 2-1/2" of travel. Each strut accepts 2-1/2"-ID VariSprings with a broad range of spring rates from which to choose. VariStruts were designed as bolt-in replacements for Strange struts to increase your travel by over 1-1/2" to 3-1/2". VariStruts with extended travel are perfect for drag classes restricted to smaller tires. They provide more front suspension travel to increase weight transfer. Available with stud or eye upper mounts. The eye mount uses a spherical bearing (COM-8 Teflon®-lined 1/2" bore x 1-1/8" wide). VariStrut offers excellent weight transfer, high-speed stability, and ease of installation for a lightweight front suspension. Installation is eased with our 2-piece, spherical-bearing control arm. With a lower pivot on the strut, the control arm adjusts to set camber and caster. The ride height is set using our lower spring seat. The upper mount can be a 5/8" stem or a spherical COM-8 bearing. The damping is adjusted by two knobs on the lower body. Positioned away from the wheel and brake disc for easy access. VariStrut is a double-adjustable strut with 16-step adjustments on both bump (compression) and rebound (extension). This allows for an unprecedented 256 combinations of control. The double-adjustable strut allows you to independently set how the car separates for weight transfer and how fast it settles down the track.

VariStrut

VariStrut
with upper eye
mount and light
weight brake kit



Part Number	Description	Price
VAS 9012124	STEM MOUNT 4"-TRAVEL DRAG-RACE STRUT SYSTEM, (PAIR)	\$2587. ⁰⁰
VAS 9012224	EYE MOUNT 4"-TRAVEL DRAG-RACE STRUT SYSTEM, (PAIR)	2587. ⁰⁰
VAS 9012326	STEM MOUNT 6"-TRAVEL DRAG-RACE STRUT SYSTEM, (PAIR)	2879. ⁰⁰
OPTIONAL	SLOTTED ROTORS, (PAIR)	30. ⁰⁰
OPTIONAL	MEDIUM DUTY BRAKES WITH 4-PISTON CALIPERS, (PAIR)	150. ⁰⁰
OPTIONAL	SPINDLE MOUNT BRAKES WITH FLOATING CALIPERS, (PAIR)	0. ⁰⁰
VAS 505-101	SPHERICAL BEARING CHASSIS MOUNT FOR STEM TOP	159. ⁰⁰
VAS 505-100	POLY PAD STRUT-TOP CHASSIS MOUNT	39. ⁰⁰
6191	VARISTRUT CONTROL ARM (PAIR)	389. ⁰⁰
6192	4130 ROD END SET OF FOUR, 7/16" BORE, 1/2" THREAD	139. ⁰⁰
6193	4130 ROD END SET OF FOUR, 1/2" BORE, 1/2" THREAD	129. ⁰⁰
6194	TIE-ROD TUBES WITH 3/8" X 7/16" 4130 ROD ENDS (PAIR)	139. ⁰⁰

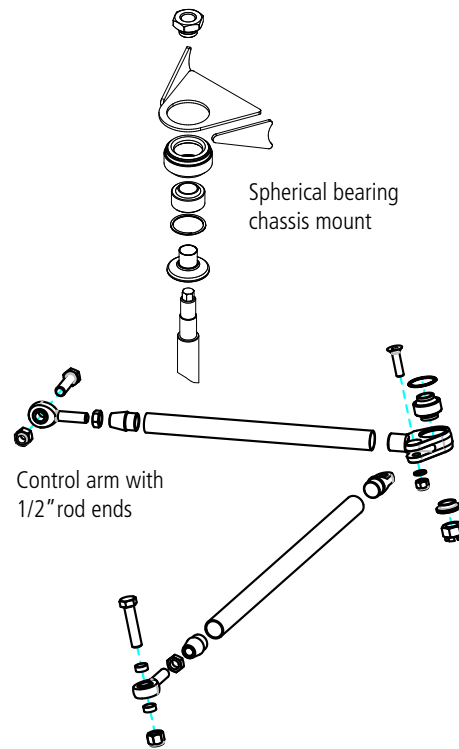

SUGGESTED SPRING RATES

Vehicle Front Weight	900-975	975-1125	1125-1275	1275-1475	1475-1650	1650-1800
9" long spring rate	185 lb/in	210 lb/in	240 lb/in	275 lb/in	310 lb/in	350 lb/in



VariStrut adjuster knob and shock body Each 16-position adjuster knob and the billet-aluminum shock body are laser-etched with directional arrows for easy reference.



VariStrut One-piece lower spring seat
An Allen wrench is all that is needed to quickly unlock and adjust VariShock's one-piece lower spring seat.

All prices subject to change. Current pricing available at www.cachassisworks.com.



A Chris Alston's Chassisworks, Inc. Brand

Chris Alston's Chassisworks, Inc.

8661 Younger Creek Dr., Sacramento CA 95828 Tel: 916-388-0288 Fax: 916-388-0295

Toll Free: 800-722-2269 www.varishock.com Email: VariShock@cachassisworks.com